

HOBIE MIRAGEDRIVE "GLIDE TECHNOLOGY"

- 80010501 MIRAGE DRIVE GT - ST FINS
- 80013501 MIRAGE DRIVE GTi - ST FINS iSeries
- 80012501 MIRAGE DRIVE GTT - ST TURBO FINS
- 80012101 MIRAGE DRIVE GTT PA17 - ST TURBO FINS

TECH TIP!

WHAT MAKES A V2 DRIVE? V2 Drums, V2 Chains, V2 Idler Cable and V2 (Threaded) masts / sprockets (USED IN 2009 production and newer)

Hobie
MirageDrive GT
shown

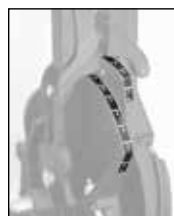

81172001 PEDAL
ADJUSTMENT DECAL

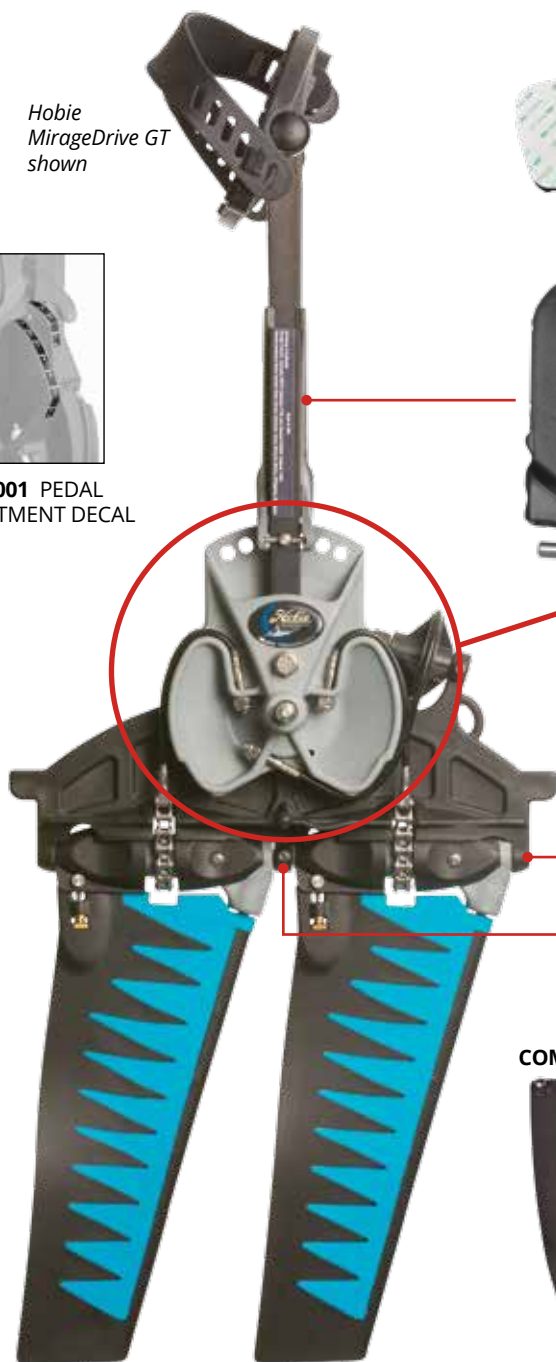

72020034 PEDAL PAD KIT

81236001 PEDAL ADJ BLK / 81236002 GRAY

ASSY INCLUDES:

- 81240 PLASTIC HANDLE GRAY
- 81230001 PIN
- 8031201 SCREW
- 81242001 SPRING
- 8034071 ALLEN WRENCH



81181001 SPINE
NEW 2013

81080001 SPROCKET SHAFT

53170020 SET SCREW

COMFORT FIN ST FIN ST TURBO FIN



81190001

81193001
(GRY/BLK)

81193021
(RED/BLK)

81193031
(BLU/BLK)

81192001
(GRY/BLK)

81192021
(RED/BLK)

81192031
(BLU/BLK)



81055001 SPROCKET GUARD FWD
8031451 SCREW



81050001 OUTHAUL BLOCK
8020041 CLEVIS PIN
10860001 LOCK RING

81129001 SPROCKET V2 THREADED (W/ FWD GUARD)
81127001 SPROCKET GT THREADED (W/ BEARINGS
AND FWD GUARD)

81156301 SPROCKET BEARINGS (12)



81163001 MAST V2 THREADED
81198101 MAST / ST TURBO V2 THREADED
8000341 LOC-TITE .5ML

UPDATE KIT - V2 SPROCKET
(2 V2 SPROCKETS AND 2 V2 MASTS)
81129022 V2 STANDARD MAST KIT
81129122 V2 TURBO MAST KIT

UPDATE KIT - GT SPROCKET
(2 GT SPROCKETS AND 2 V2 MASTS)
81129023 GT STANDARD MAST KIT
81129123 GTT TURBO MAST KIT



- 81175001 DRUM GT W/ BEARINGS
- 81156401 DRUM BEARINGS (15)
- 81202001 CHAIN ASSY V2
- 8050111 NUT
- 81090001 DRUM SHAFT V2 FITS ALL MODELS
- DRIVE SEAL**
- 81037001 STD
- 81038001 I - SERIES
- 8031581 SCREW
- 8080461 WASHER
- 81155001 BOLT

HOBIE MIRAGEDRIVE "V2" / "GT"

- 81123001 IDLER PULLEY GT W/ BEARINGS
- 81126201 IDLER BEARINGS (12)
- 81203001 IDLER CABLE V2 (18.5")
- 8050111 NUT

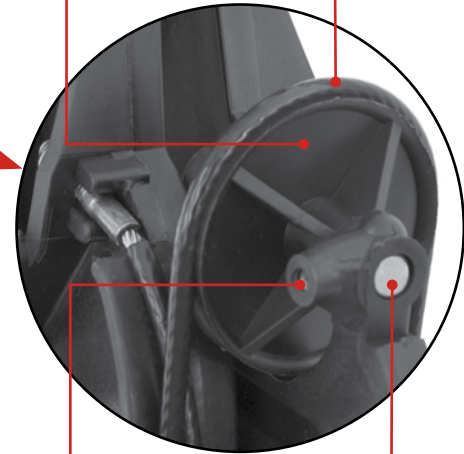
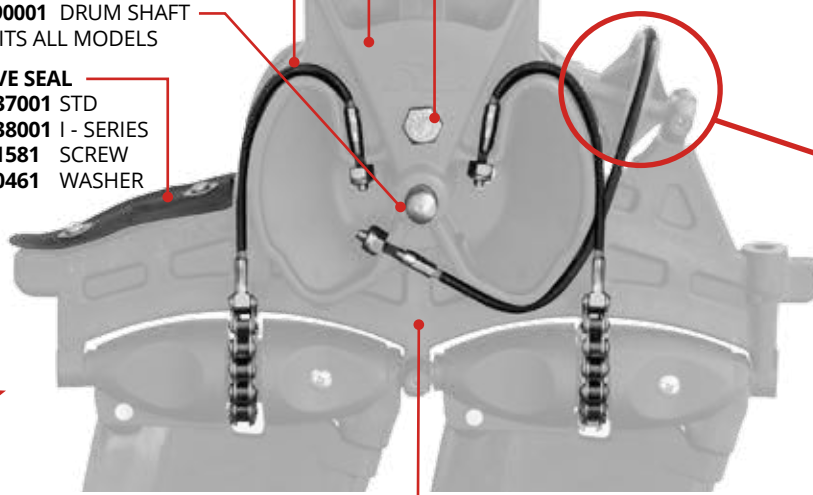

81095001 DRIVE ALIGNMENT PIN 2012+

53170020 SET SCREW

81110001 PULLEY SHAFT

HOBIE MIRAGEDRIVE "V1" (V1 PARTS LIMITED TO STOCK ON HAND)

Drive with older plastic drum, plastic spine, Sprocket / mast connection is a set-screw

81171002 V1 to V2 UPDATE KIT V2 DRUMS, CHAINS, IDLER

81171001 V1 DRUM

8050111 NUT

81155001 BOLT
8050540 NUT

IDLER CABLE - 14 1/4" NLA
8050111 NUT

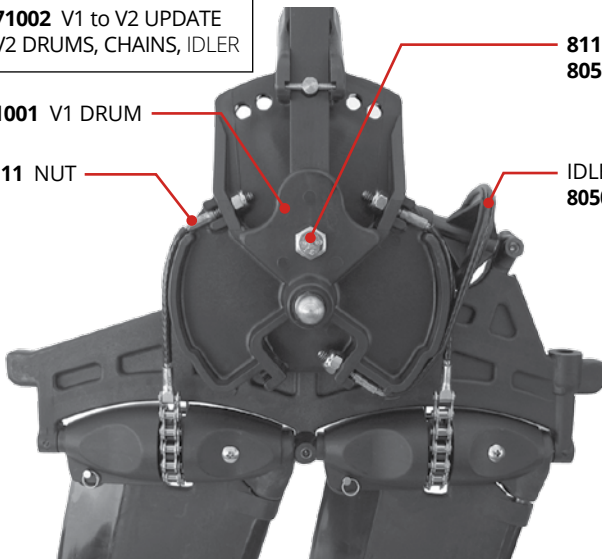

TECH TIP!

MAINTENANCE AND TUNING - Maintenance and tuning information for MirageDrives is available on the Hobie Cat website support area. Click the kayak model name then see Care and Maintenance.

Direct link to the support pages for kayaks is here:
<http://www.hobiekatyaks.com/support/>

81128001 V1 SPROCKET



53170020 SET SCREW

V1 Sprocket / mast connection uses a set-screw

UPDATE KIT - V2 SPROCKET
(2 V2 SPROCKETS and 2 V2 MASTS)
81129022 V2 STANDARD MAST KIT
81129122 V2 TURBO MAST KIT

81160001 OLDER / V1 MAST / STD
81198001 OLDER / V1 MAST / ST TURBO

MIRAGEDRIVE SPARE PARTS KITS

Spare parts kits include a fin, mast, sprocket, chain and appropriate parts for the drive version. Older drives have sprockets and masts that use a set screw connection. V2 drives use threaded sprockets and masts. All in a handy zippered pouch. Don't waste a day on the water when your MirageDrive could be easily repaired. Available for the standard fin drive or a drive with the ST Turbo fins. Standard kit shown.



MIRAGEDRIVE V2 (THREADED MAST)
80010301 KIT V2 COMFORT FIN
80013301 KIT V2 TURBO FIN

MIRAGEDRIVE GT (THREADED MAST)
80010401 GT ST (Bearing Sprocket)
80013401 GT TURBO (Bearing Sprocket)

HOBIE MIRAGEDRIVE— OLDER—

Original drive with aluminum spine, stainless sprocket / mast connection is cotter key. Limited parts available.

- 81130001 SPROCKET (STAINLESS)
- 81340001 SPROCKET BUSHING (SS SPKT)
- 8060111 COTTER KEY (MAST / SS SPKT)
- 8020061 CLEVIS PIN
- 10860001 LOCK RING
- 81211001 IDLER CABLE 14 3/4" (SOLID PULLEY)
- 81150001 DRUM BUSHING (ALUM DRUM)
- 81105001 CRANK ARM RIGHT, THREADED